

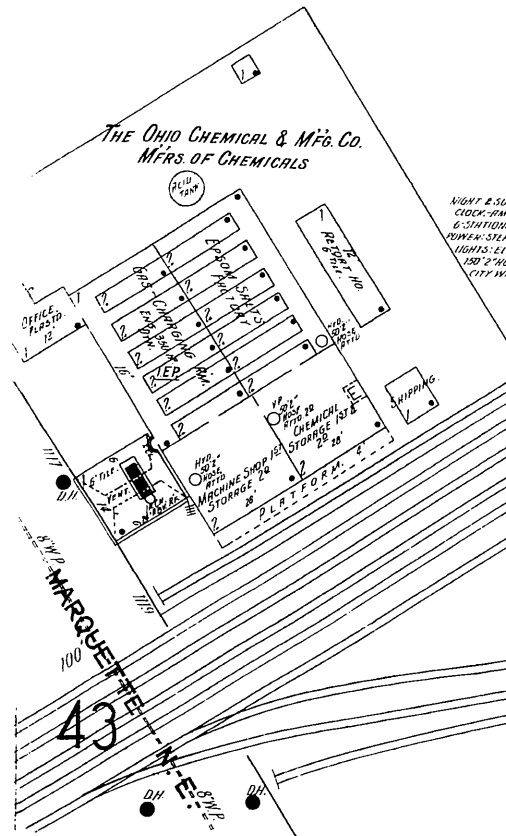

L a k e
E r i e

E r i e



NIGHT & SUNDAY WATCHMAN - CLEVELAND BARGE CO. CLOCK - AMERICAN WATCHMAN TIME IN FACTORY. 6 SIGHTINGS - HALF HOURLY SOUNDINGS. - BURNER - STEAM & ELECTRIC - HEAT - STEAM - FUEL - COAL. LIGHTS - ELECTRIC. 100' 2" HOSE ATTACHED TO HYDRA HOSE SHOWING - CITY WATER.

THE BISHOP-BABCOCK-BECKER CO.
MFRS. OF SODA FOUNTAINS & BRASS BAR FIXTURES.
55TH ST. PLANT.

NIGHT & SUNDAY WATCHMAN - AMERICAN WATCHMAN. CO. CLOCK - POWER & HEAT - STEAM - FUEL - COAL & SHAVINGS. LITTER BLOWN TO VENT IN METAL. COVERED. 2" HOSE. HOSE WITH HOSE ATT. BYNELL AUTOMATIC SPRINKLERS. IN BLDG. A. C. D. E. F. H. I. AND HEADS IN G. & SHEETS. ROOF 600' HEADS. SPACED 10' IN WET SYSTEM. PRIMARY SUPPLY DIRECT CITY PRESSURE. 12 LBS. RESERVE. SUPPLY SECONDARY SUPPLY THROUGH ONE-SIDE & SUPPLY 24" DIA. HIGHEST HEAD. KNIVES UNDERWRITER P. A. SIZE 1850' 1/2" ONLY 750' ONLY 1/2" DIA. HIGHEST HEAD. KNIVES FROM 1800' ONLY. COILS FILLED BY 8" CITY MAIN TANK. 2" TANKS. MILLER 20" CHEMICAL ENGINE. 6" MILLER 36" EXTRACTORS.

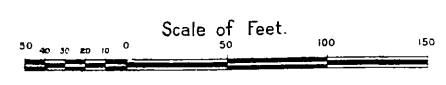

53

65
5/24/12