

471

471

424

(401)  
"A" HARRISON TWP  
SEPT. 1955

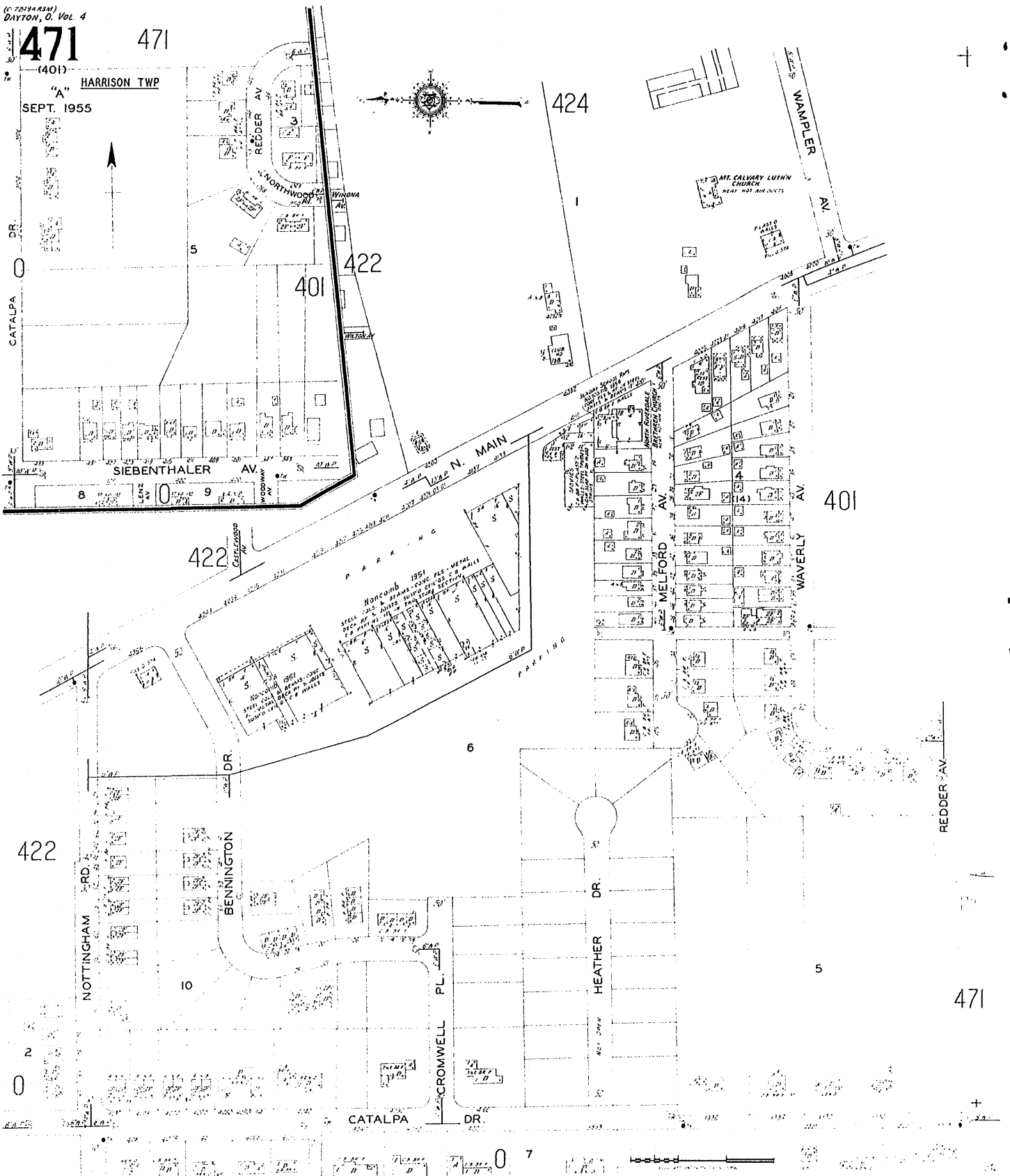

5

422

401

SIEBENTHALER AV.

N. MAIN

422

PARKING

NONCOMB 1951  
FIRE STATION  
SPEL 312 S. STANLEY - CONC. FIB - VERVAL  
REAR OF BLDG. W. DIST. TANKS - 22' 0" DIAM.  
SPEL 312 S. STANLEY - CONC. FIB - VERVAL  
REAR OF BLDG. W. DIST. TANKS - 22' 0" DIAM.

401

MELFORD AV.

WAVERLY AV.

6

422

NOTTINGHAM DR.

BENNINGTON DR.

HEATHER DR.

CROMWELL PL.

CATALPA DR.

5

471

0 7